



Longfield Solar Farm

Land Plans

Document Reference : EN010118/APP/2.1(A)

Deadline 2

Revision 2.0

September 2022

Longfield Solar Energy Farm Ltd

Land Plans – Revisions Schedule

Drawing Title	Revision	Drawing Number	Reason for Revision
Land Plan Key Plan	C01	GH-125724005-LP-0	No change made.
Land Plan Sheet 1 of 9	C02	GH-125724005-LP-1	To reflect changes to the Order land as a result of further clarity around the land and rights required for the Scheme.
Land Plan Sheet 2 of 9	C01	GH-125724005-LP-2	No change made.
Land Plan Sheet 3 of 9	C01	GH-125724005-LP-3	No change made.
Land Plan Sheet 4 of 9	C01	GH-125724005-LP-4	No change made.
Land Plan Sheet 5 of 9	C01	GH-125724005-LP-5	No change made.
Land Plan Sheet 6 of 9	C01	GH-125724005-LP-6	No change made.
Land Plan Sheet 7 of 9	C01	GH-125724005-LP-7	No change made.
Land Plan Sheet 8 of 9	C01	GH-125724005-LP-8	No change made.
Land Plan Sheet 9 of 9	C01	GH-125724005-LP-9	No change made.

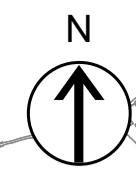

COPYRIGHT GATELEY HAMER LIMITED. THIS DOCUMENT HAS BEEN PREPARED PURSUANT TO AND SUBJECT TO THE TERMS OF APPOINTMENT BY THE CLIENT AND FOR THE SPECIFIC PURPOSES CONNECTED WITH THE PROJECT ONLY. IT SHOULD NOT BE RELIED UPON BY ANY OTHER PARTY OR USED FOR ANY OTHER PURPOSE. GATELEY HAMER ACCEPTS NO LIABILITY WHICH MAY ARISE FROM RELIANCE OR USE OF THIS DOCUMENT OR THE DATA CONTAINED HEREIN BY ANY OTHER PARTY OR FOR ANY OTHER PURPOSE.

- Notes
1. DO NOT SCALE FROM THIS DRAWING. USE ONLY PRINTED DIMENSIONS
 2. ALL DIMENSIONS ARE IN METRES UNLESS STATED OTHERWISE
 3. THIS DRAWING IS TO BE READ IN CONJUNCTION WITH ALL OTHER RELEVANT DOCUMENTATION

- Key to Symbols
- Order limits – the area within which the authorised development may be carried out
 - For clarity, land hatched does not fall within the Order limits or Order land.
 - Districts of Chelmsford and Braintree

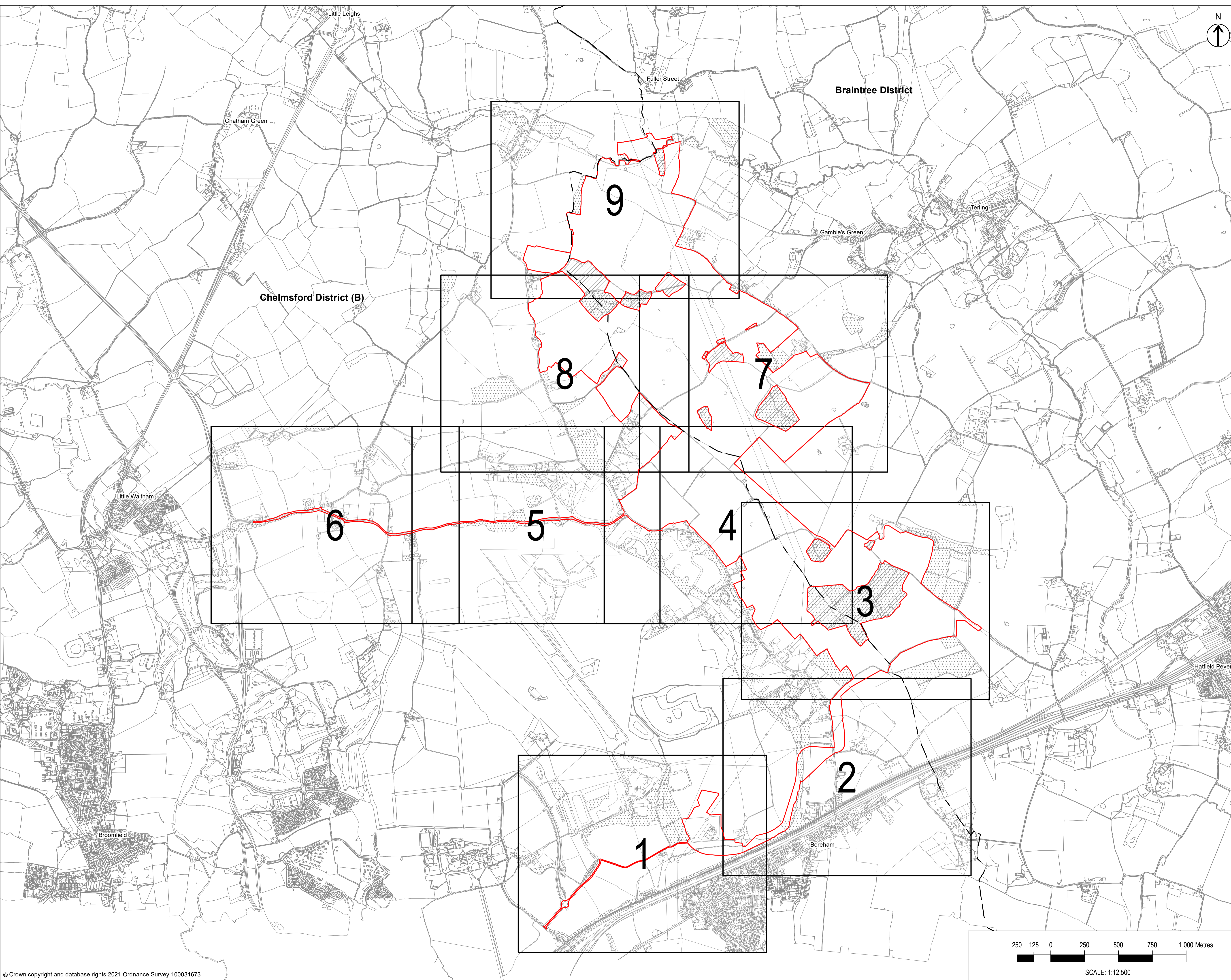

CO1	First Issue	24/02/22	AH	SM	MD
Rev	Description	Date	By	Check	Approved

Purpose of Issue
DCO APPLICATION

Gateley / HAMER
 One Eleven Edmund Street
 Birmingham
 B3 2HJ
 Client
 Tel: 0121 234 0000
 Web: gateleyhamer.com

LONGFIELD SOLAR ENERGY FARM LIMITED

Project Title
LONGFIELD SOLAR FARM

Drawing Title
LAND PLAN IN ACCORDANCE WITH REGULATION 5(2)(i) OF THE INFRASTRUCTURE PLANNING (APPLICATIONS: PRESCRIBED FORMS AND PROCEDURE) REGULATIONS 2009 SHEET 0 OF 9

Drawn	Checked	Approved	Date
AH	SM	MD	24/02/22

GH Project Number
125724.005

Scale at A1
1:12,500

Drawing Number	Revision
GH-125724005-LP-0	C01

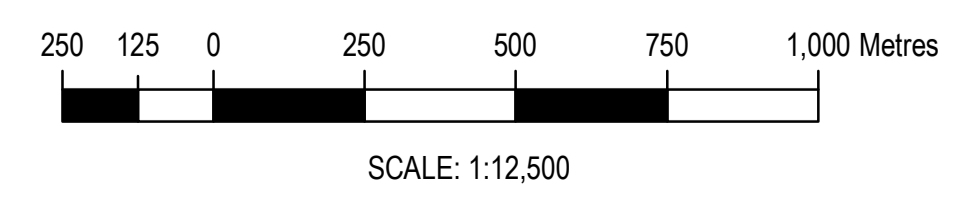

COPYRIGHT GATELEY HAMER LIMITED. THIS DOCUMENT HAS BEEN PREPARED PURSUANT TO AND SUBJECT TO THE TERMS OF APPOINTMENT BY THE CLIENT AND FOR THE SPECIFIC PURPOSES CONNECTED WITH THE PROJECT ONLY. IT SHOULD NOT BE RELIED UPON BY ANY OTHER PARTY OR USED FOR ANY OTHER PURPOSE. GATELEY HAMER ACCEPTS NO LIABILITY WHICH MAY ARISE FROM RELIANCE OR USE OF THIS DOCUMENT OR THE DATA CONTAINED HEREIN BY ANY OTHER PARTY OR FOR ANY OTHER PURPOSE.

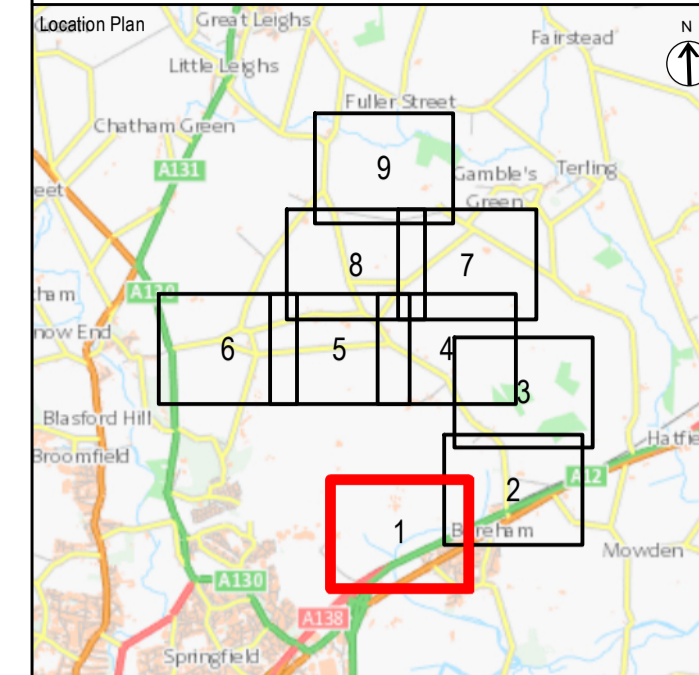

- Notes
- DO NOT SCALE FROM THIS DRAWING. USE ONLY PRINTED DIMENSIONS
 - ALL DIMENSIONS ARE IN METRES UNLESS STATED OTHERWISE
 - THIS DRAWING IS TO BE READ IN CONJUNCTION WITH ALL OTHER RELEVANT DOCUMENTATION

- Key to Symbols
- Order limits – the area within which the authorised development may be carried out.
 - For clarity land hatched does not fall within the Order limits or Order land.
 - Order land - freehold to be compulsorily acquired and in relation to which it is proposed to extinguish easements, servitudes and other private rights.
 - Order land - temporary use of land and during any period of temporary possession the exercise of easements, servitudes and other private rights are to be suspended.
 - Order land - new rights to be compulsorily acquired and restrictive covenants to be imposed and land in relation to which existing easements, servitudes and other private rights the exercise of which is inconsistent with the rights and restrictions acquired pursuant to the Order are to be extinguished.
 - Order land - new rights to be compulsorily acquired and restrictive covenants to be imposed and land in relation to which existing easements, servitudes and other private rights the exercise of which is inconsistent with the rights and restrictions acquired pursuant to the Order are to be extinguished. No new rights to be compulsorily acquired, restrictive covenants imposed, nor extinguishment of existing rights etc. in relation to the subsol of this Order land.
 - Order land – in respect of subsol only freehold to be compulsorily acquired and in relation to which it is proposed to extinguish easement, servitudes and other private rights.
- Districts of Chelmsford and Braintree
 - - - - - Public Right of Way
 --- Brideway

CO2	Plots Updated	02/09/22	SM	CG	BW
CO1	First Issue	24/02/22	AH	SM	MD
Rev	Description	Date	By	Check	Approved

Purpose of Issue
DCO APPLICATION

Gateley / HAMER
 One Eleven Edmund Street
 Birmingham B3 2HJ
 Client
 Tel: 0121 234 0000
 Web: gateleyhamer.com

LONGFIELD SOLAR ENERGY FARM LIMITED

Project Title
LONGFIELD SOLAR FARM

Drawing Title
LAND PLAN IN ACCORDANCE WITH REGULATION 5(2)(i) OF THE INFRASTRUCTURE PLANNING (APPLICATIONS: PRESCRIBED FORMS AND PROCEDURE) REGULATIONS 2009
SHEET 1 OF 9

Drawn	Checked	Approved	Date
SM	CG	BW	02/09/22
GH Project Number	Scale at A1		
125724.005	1:2,500		
Drawing Number	Revision		
GH-125724005-LP-1	C02		

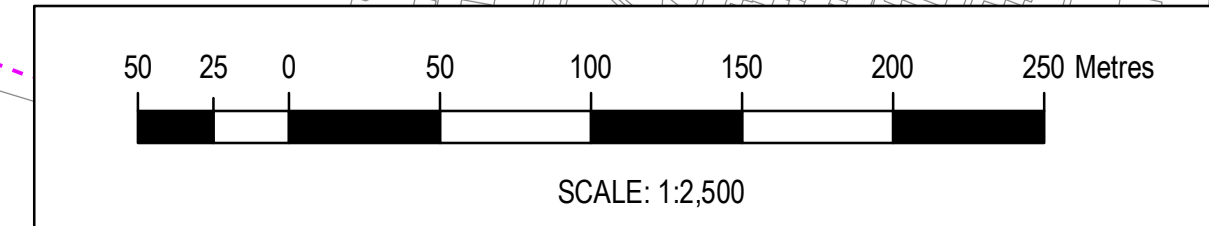
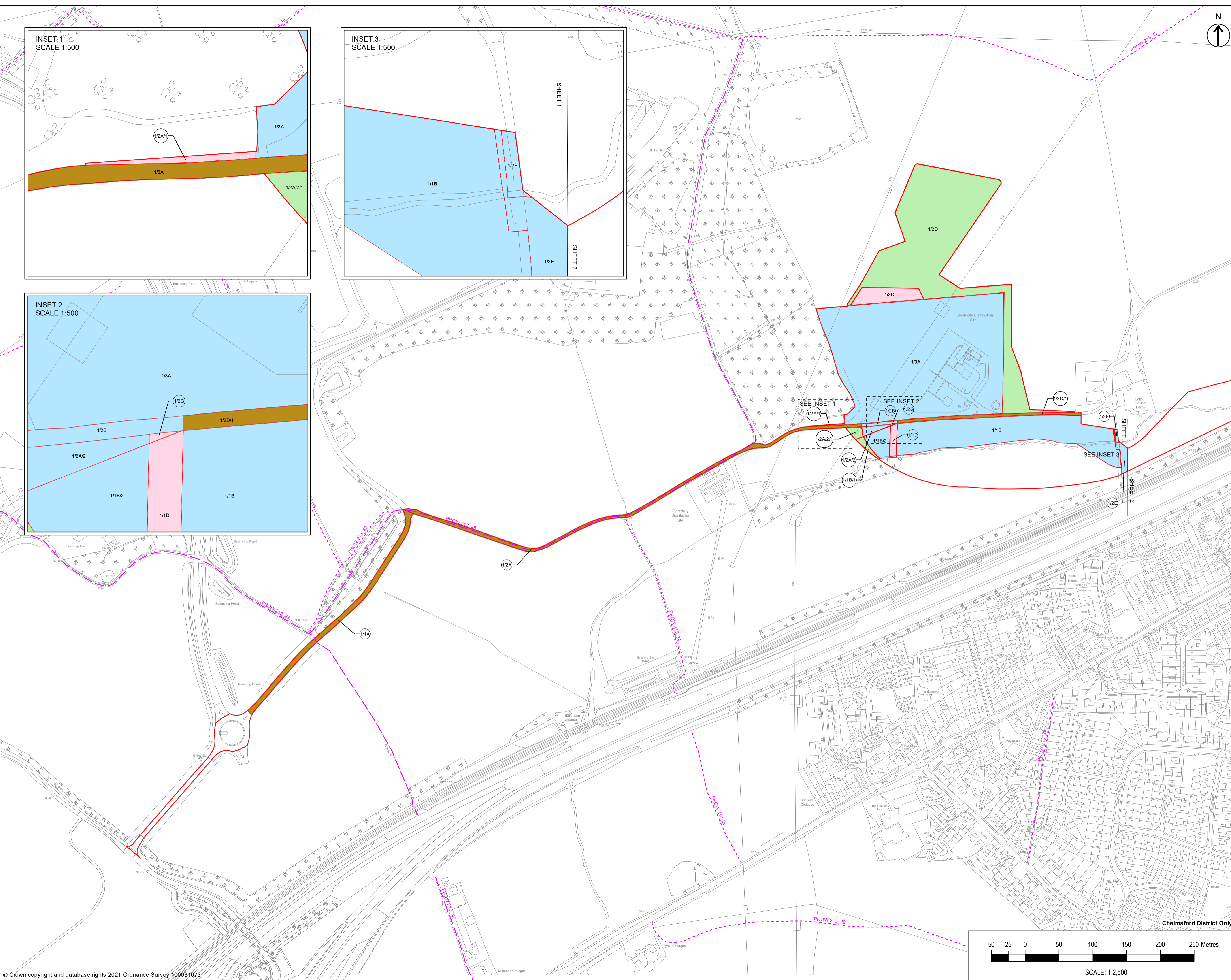
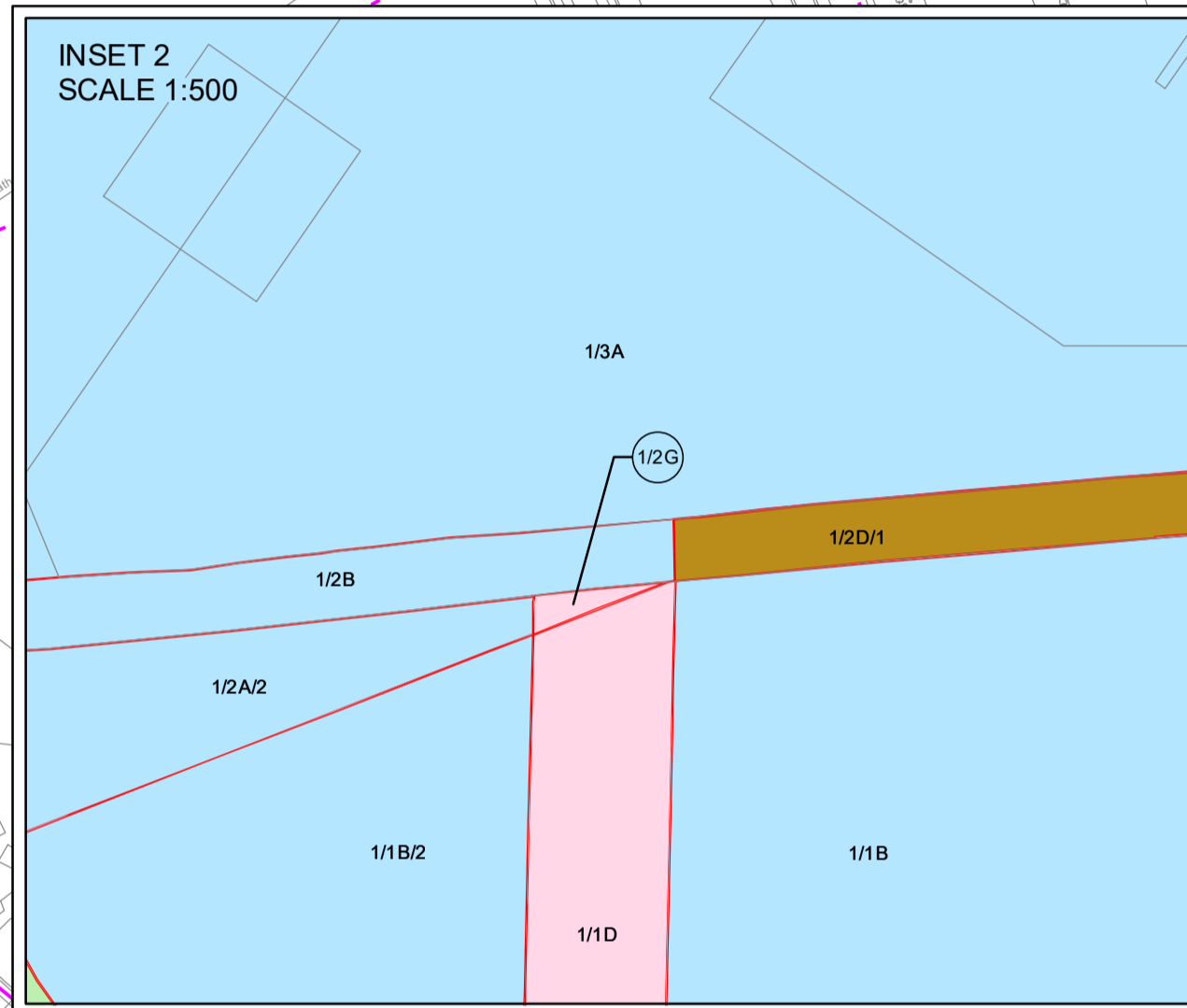
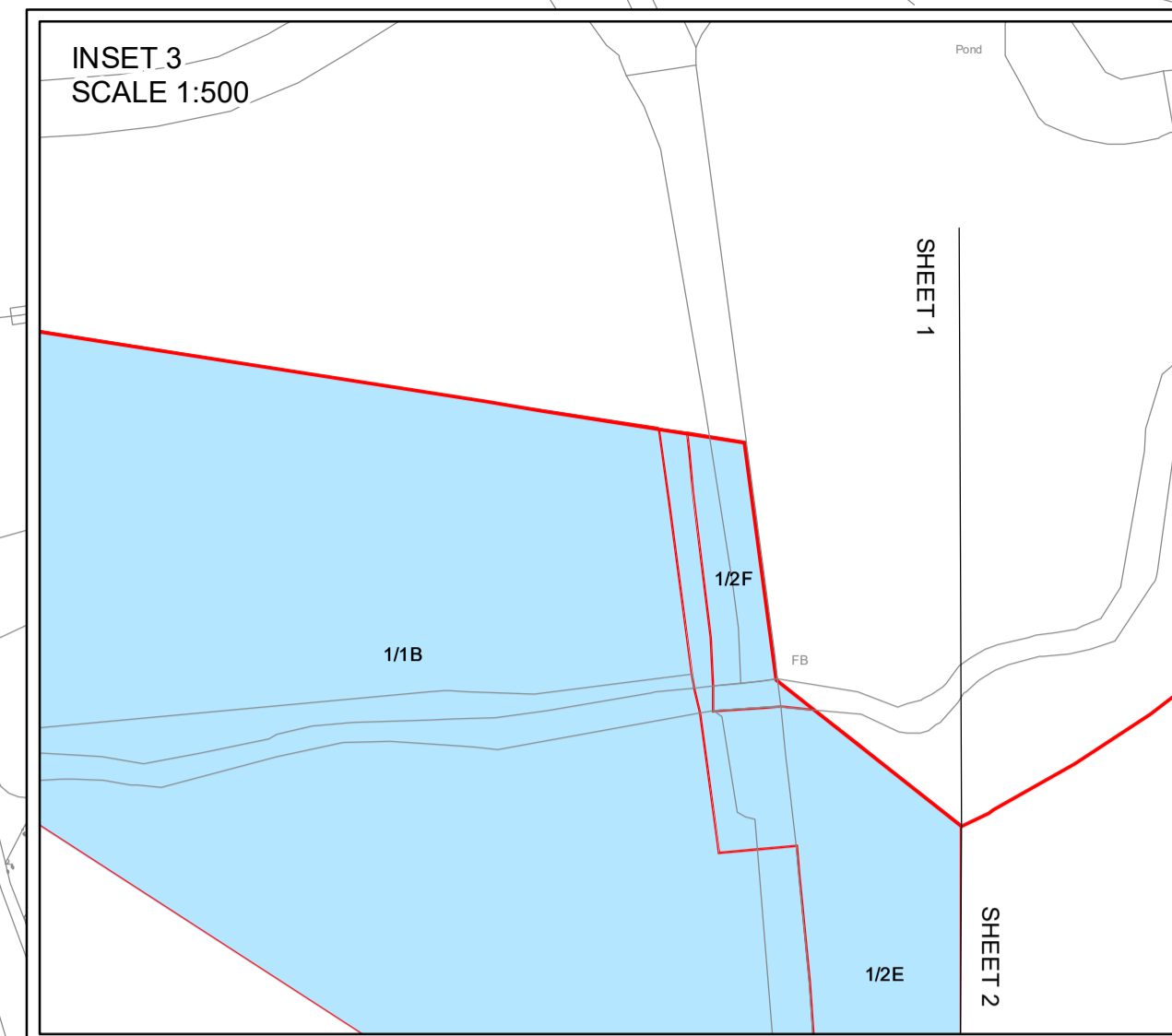
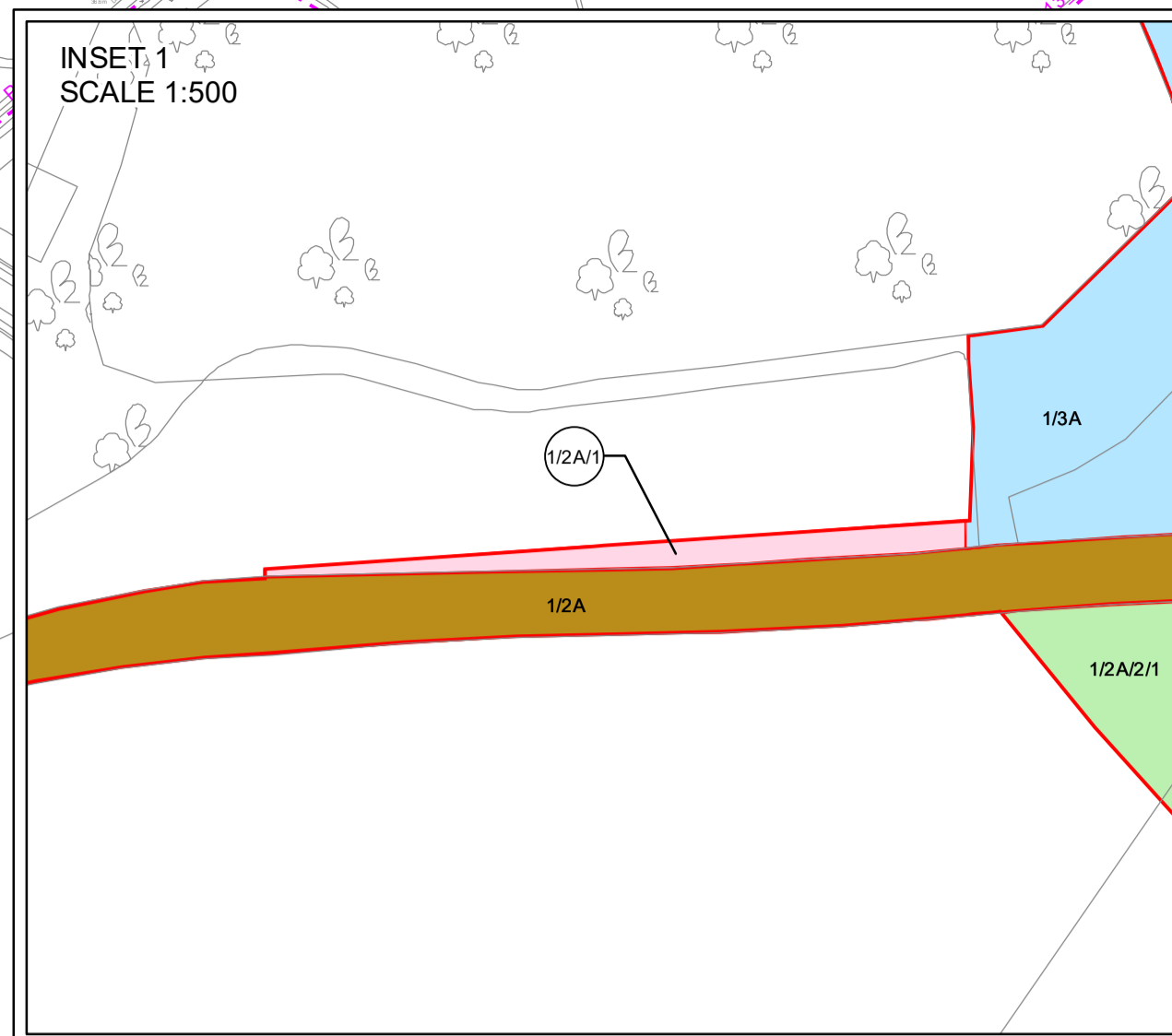

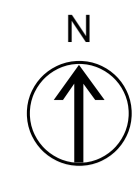

COPYRIGHT GATELEY HAMER LIMITED. THIS DOCUMENT HAS BEEN PREPARED PURSUANT TO AND SUBJECT TO THE TERMS OF APPOINTMENT BY THE CLIENT AND FOR THE SPECIFIC PURPOSES CONNECTED WITH THE PROJECT ONLY. IT SHOULD NOT BE RELIED UPON BY ANY OTHER PARTY OR USED FOR ANY OTHER PURPOSE. GATELEY HAMER ACCEPTS NO LIABILITY WHICH MAY ARISE FROM RELIANCE OR USE OF THIS DOCUMENT OR THE DATA CONTAINED HEREIN BY ANY OTHER PARTY OR FOR ANY OTHER PURPOSE.

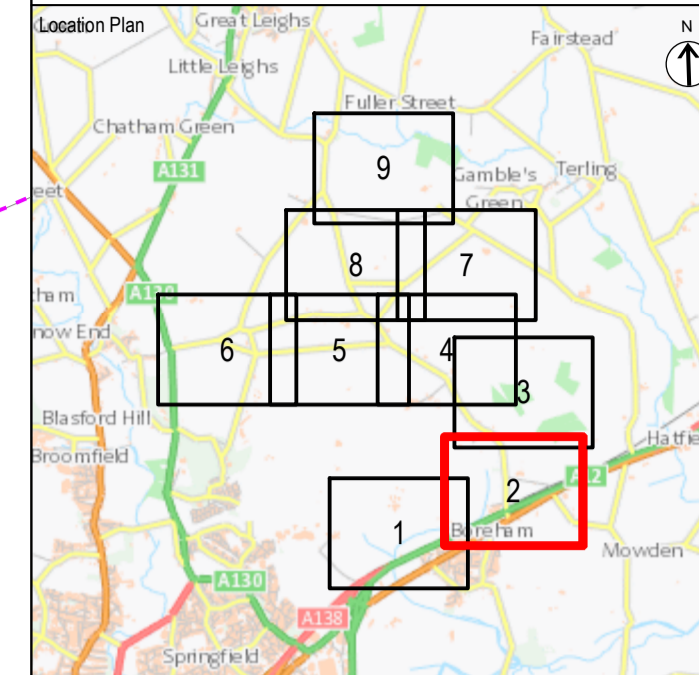

Notes

1. DO NOT SCALE FROM THIS DRAWING. USE ONLY PRINTED DIMENSIONS
2. ALL DIMENSIONS ARE IN METRES UNLESS STATED OTHERWISE
3. THIS DRAWING IS TO BE READ IN CONJUNCTION WITH ALL OTHER RELEVANT DOCUMENTATION

Key to Symbols

- Order limits – the area within which the authorised development may be carried out.
- For clarity, land hatched does not fall within the Order limits or Order land.
- Order land – freehold to be compulsorily acquired and in relation to which it is proposed to extinguish easements, servitudes and other private rights.
- Order land – temporary use of land and during any period of temporary possession the exercise of easements, servitudes and other private rights are to be suspended.
- Order land – new rights to be compulsorily acquired and restrictive covenants to be imposed and land in relation to which existing easements, servitudes and other private rights the exercise of which is inconsistent with the rights and restrictions acquired pursuant to the Order are to be extinguished.
- Order land – new rights to be compulsorily acquired and restrictive covenants to be imposed and land in relation to which existing easements, servitudes and other private rights the exercise of which is inconsistent with the rights and restrictions acquired pursuant to the Order are to be extinguished. No new rights to be compulsorily acquired, restrictive covenants imposed, nor extinguishment of existing rights etc, in relation to the subsol of this Order land.
- Order land – in respect of subsol only freehold to be compulsorily acquired and in relation to which it is proposed to extinguish easement, servitudes and other private rights.
- Districts of Chelmsford and Braintree
- Public Right of Way
- Bridleway

CO1	First Issue	24/02/22	AH	SM	MD
Rev	Description	Date	By	Check	Approved

Purpose of Issue
DCO APPLICATION

Gateley / HAMER
 One Eleven Edmund Street
 Birmingham B3 2HJ
 Client
 Tel: 0121 234 0000
 Web: gateleyhamer.com

LONGFIELD SOLAR ENERGY FARM LIMITED

Project Title
LONGFIELD SOLAR FARM

Drawing Title
LAND PLAN IN ACCORDANCE WITH REGULATION 5(2)(i) OF THE INFRASTRUCTURE PLANNING (APPLICATIONS: PRESCRIBED FORMS AND PROCEDURE) REGULATIONS 2009 SHEET 2 OF 9

Drawn	Checked	Approved	Date
AH	SM	MD	24/02/22
GH Project Number	Scale at A1		
125724.005	1:2,500		
Drawing Number	Revision		
GH-125724005-LP-2	C01		

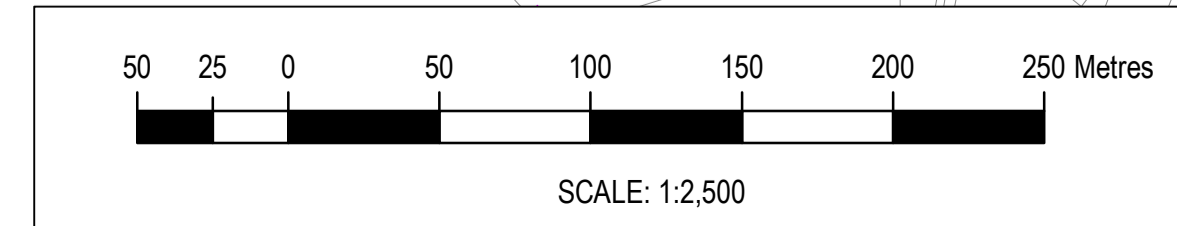
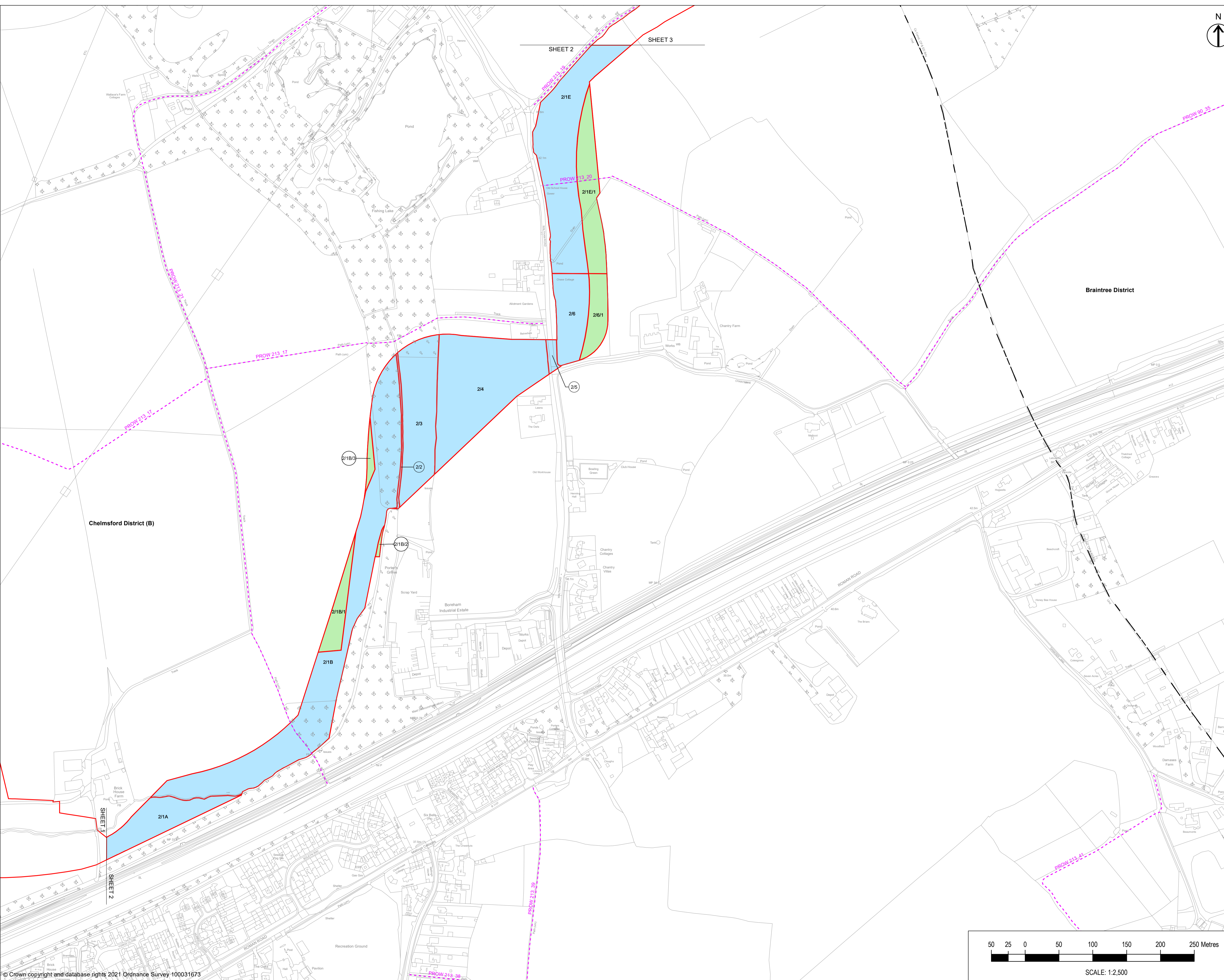

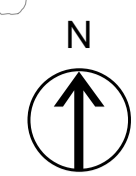

COPYRIGHT GATELEY HAMER LIMITED. THIS DOCUMENT HAS BEEN PREPARED PURSUANT TO AND SUBJECT TO THE TERMS OF APPOINTMENT BY THE CLIENT AND FOR THE SPECIFIC PURPOSES CONNECTED WITH THE PROJECT ONLY. IT SHOULD NOT BE RELIED UPON BY ANY OTHER PARTY OR USED FOR ANY OTHER PURPOSE. GATELEY HAMER ACCEPTS NO LIABILITY WHICH MAY ARISE FROM RELIANCE OR USE OF THIS DOCUMENT OR THE DATA CONTAINED HEREIN BY ANY OTHER PARTY OR FOR ANY OTHER PURPOSE.

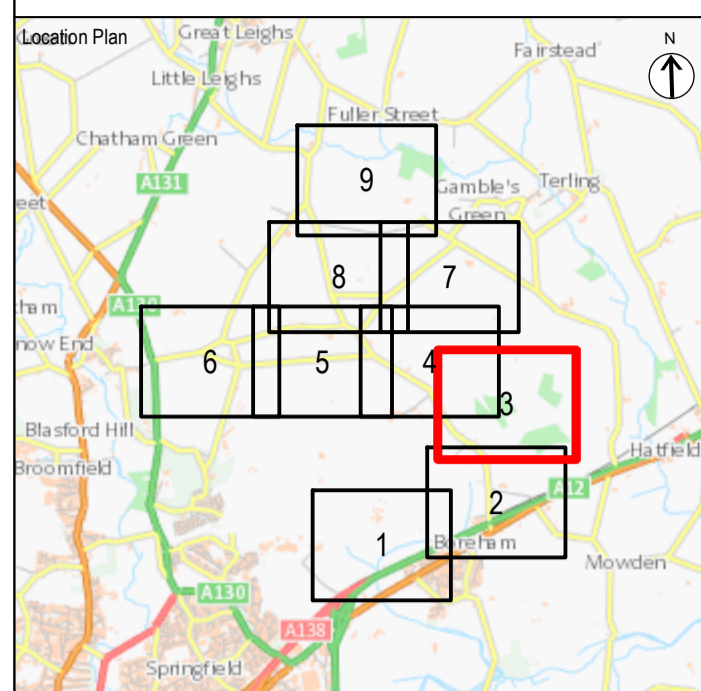

Notes
 1. DO NOT SCALE FROM THIS DRAWING. USE ONLY PRINTED DIMENSIONS
 2. ALL DIMENSIONS ARE IN METRES UNLESS STATED OTHERWISE
 3. THIS DRAWING IS TO BE READ IN CONJUNCTION WITH ALL OTHER RELEVANT DOCUMENTATION

- Key to Symbols
- Order limits - the area within which the authorised development may be carried out.
 - For clarity, land hatched does not fall within the Order limits or Order land.
 - Order land - freehold to be compulsorily acquired and in relation to which it is proposed to extinguish easements, servitudes and other private rights.
 - Order land - temporary use of land and during any period of temporary possession the exercise of easements, servitudes and other private rights are to be suspended.
 - Order land - new rights to be compulsorily acquired and restrictive covenants to be imposed and land in relation to which existing easements, servitudes and other private rights the exercise of which is inconsistent with the rights and restrictions acquired pursuant to the Order are to be extinguished.
 - Order land - new rights to be compulsorily acquired and restrictive covenants to be imposed and land in relation to which existing easements, servitudes and other private rights the exercise of which is inconsistent with the rights and restrictions acquired pursuant to the Order are to be extinguished. No new rights to be compulsorily acquired, restrictive covenants imposed, nor extinguishment of existing rights etc, in relation to the subsoil of this Order land.
 - Order land - in respect of subsoil only freehold to be compulsorily acquired and in relation to which it is proposed to extinguish easement, servitudes and other private rights.
 - Districts of Chelmsford and Braintree
 - Public Right of Way
 - Bridleway

CD1	First Issue	24/02/22	AH	SM	MD
Rev	Description	Date	By	Check	Approved

Purpose of Issue
 DCO APPLICATION

Gateley / HAMER

One Eleven Edmund Street
 Birmingham B3 2HJ
 Client

Tel: 0121 234 0000
 Web: gateleyhamer.com

LONGFIELD SOLAR ENERGY FARM LIMITED

Project Title
LONGFIELD SOLAR FARM

Drawing Title
LAND PLAN IN ACCORDANCE WITH REGULATION 5(2)(i) OF THE INFRASTRUCTURE PLANNING (APPLICATIONS: PRESCRIBED FORMS AND PROCEDURE) REGULATIONS 2009 SHEET 3 OF 9

Drawn	Checked	Approved	Date
AH	SM	MD	24/02/22

GH Project Number
 125724.005

Scale at A1
 1:2,500

Drawing Number
 GH-125724005-LP-3

Revision
 C01

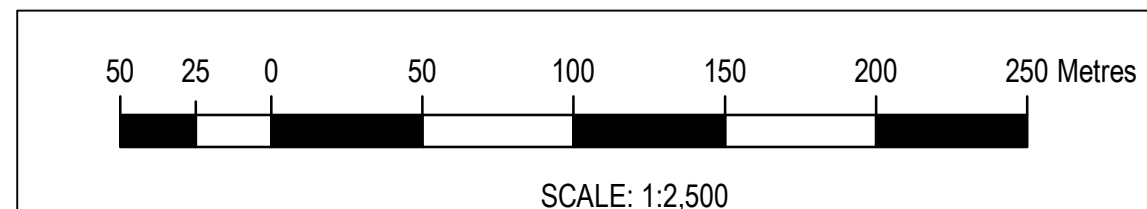
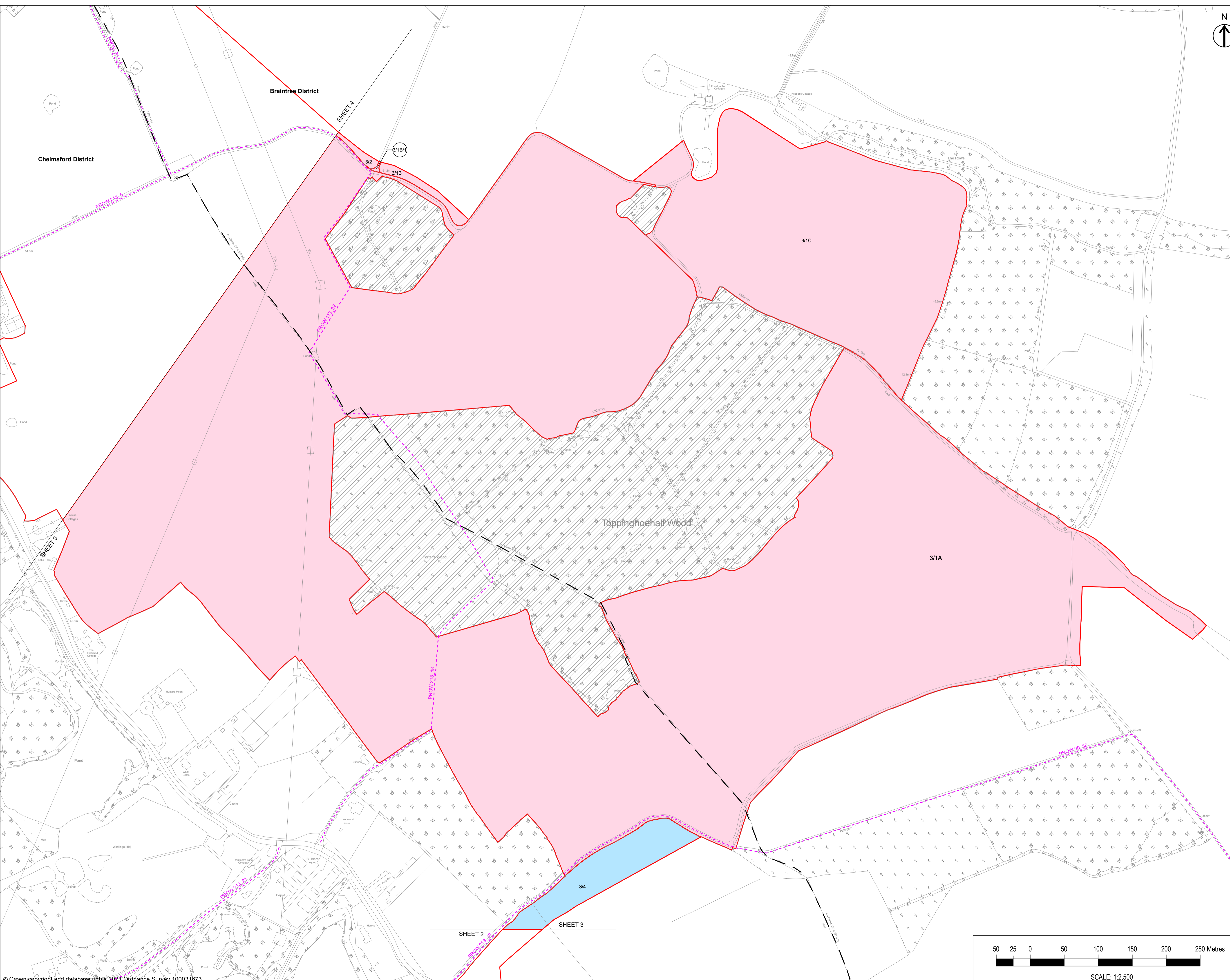

COPYRIGHT GATELEY HAMER LIMITED. THIS DOCUMENT HAS BEEN PREPARED PURSUANT TO AND SUBJECT TO THE TERMS OF APPOINTMENT BY THE CLIENT AND FOR THE SPECIFIC PURPOSES CONNECTED WITH THE PROJECT ONLY. IT SHOULD NOT BE RELIED UPON BY ANY OTHER PARTY OR USED FOR ANY OTHER PURPOSE. GATELEY HAMER ACCEPTS NO LIABILITY WHICH MAY ARISE FROM RELIANCE OR USE OF THIS DOCUMENT OR THE DATA CONTAINED HEREIN BY ANY OTHER PARTY OR FOR ANY OTHER PURPOSE.

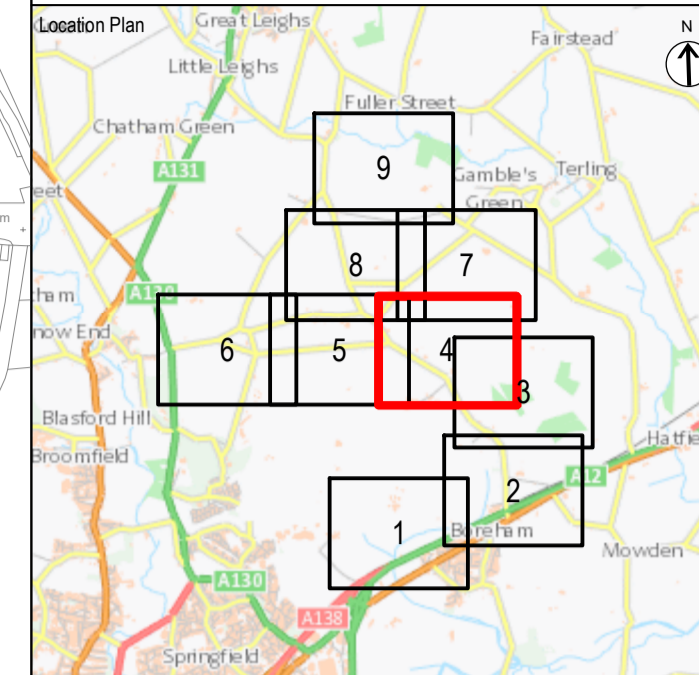

- Notes
- DO NOT SCALE FROM THIS DRAWING. USE ONLY PRINTED DIMENSIONS
 - ALL DIMENSIONS ARE IN METRES UNLESS STATED OTHERWISE
 - THIS DRAWING IS TO BE READ IN CONJUNCTION WITH ALL OTHER RELEVANT DOCUMENTATION

Key to Symbols

- Order limits - the area within which the authorised development may be carried out.
- For clarity, land hatched does not fall within the Order limits or Order land.
- Order land - freehold to be compulsorily acquired and in relation to which it is proposed to extinguish easements, servitudes and other private rights.
- Order land - temporary use of land and during any period of temporary possession the exercise of easements, servitudes and other private rights are to be suspended.
- Order land - new rights to be compulsorily acquired and restrictive covenants to be imposed and land in relation to which existing easements, servitudes and other private rights the exercise of which is inconsistent with the rights and restrictions acquired pursuant to the Order are to be extinguished.
- Order land - new rights to be compulsorily acquired and restrictive covenants to be imposed and land in relation to which existing easements, servitudes and other private rights the exercise of which is inconsistent with the rights and restrictions acquired pursuant to the Order are to be extinguished. No new rights to be compulsorily acquired, restrictive covenants imposed, nor extinguishment of existing rights etc, in relation to the subsoil of this Order land.
- Order land - in respect of subsoil only freehold to be compulsorily acquired and in relation to which it is proposed to extinguish easement, servitudes and other private rights.
- Districts of Chelmsford and Braintree
- Public Right of Way
- Bridleway

CD1	First Issue	24/02/22	AH	SM	MD
Rev	Description	Date	By	Check	Approved

Purpose of Issue
DCO APPLICATION

Gateley / HAMER
 One Eleven Edmund Street
 Birmingham B3 2HJ
 Client
 Tel: 0121 234 0000
 Web: gateleyhamer.com

LONGFIELD SOLAR ENERGY FARM LIMITED

LONGFIELD SOLAR FARM

Project Title
LAND PLAN IN ACCORDANCE WITH REGULATION 5(2)(i) OF THE INFRASTRUCTURE PLANNING (APPLICATIONS: PRESCRIBED FORMS AND PROCEDURE) REGULATIONS 2009
SHEET 4 OF 9

Drawn	Checked	Approved	Date
AH	SM	MD	24/02/22
GH Project Number	Scale at A1		
125724.005	1:2,500		
Drawing Number	Revision		
GH-125724005-LP-4	C01		

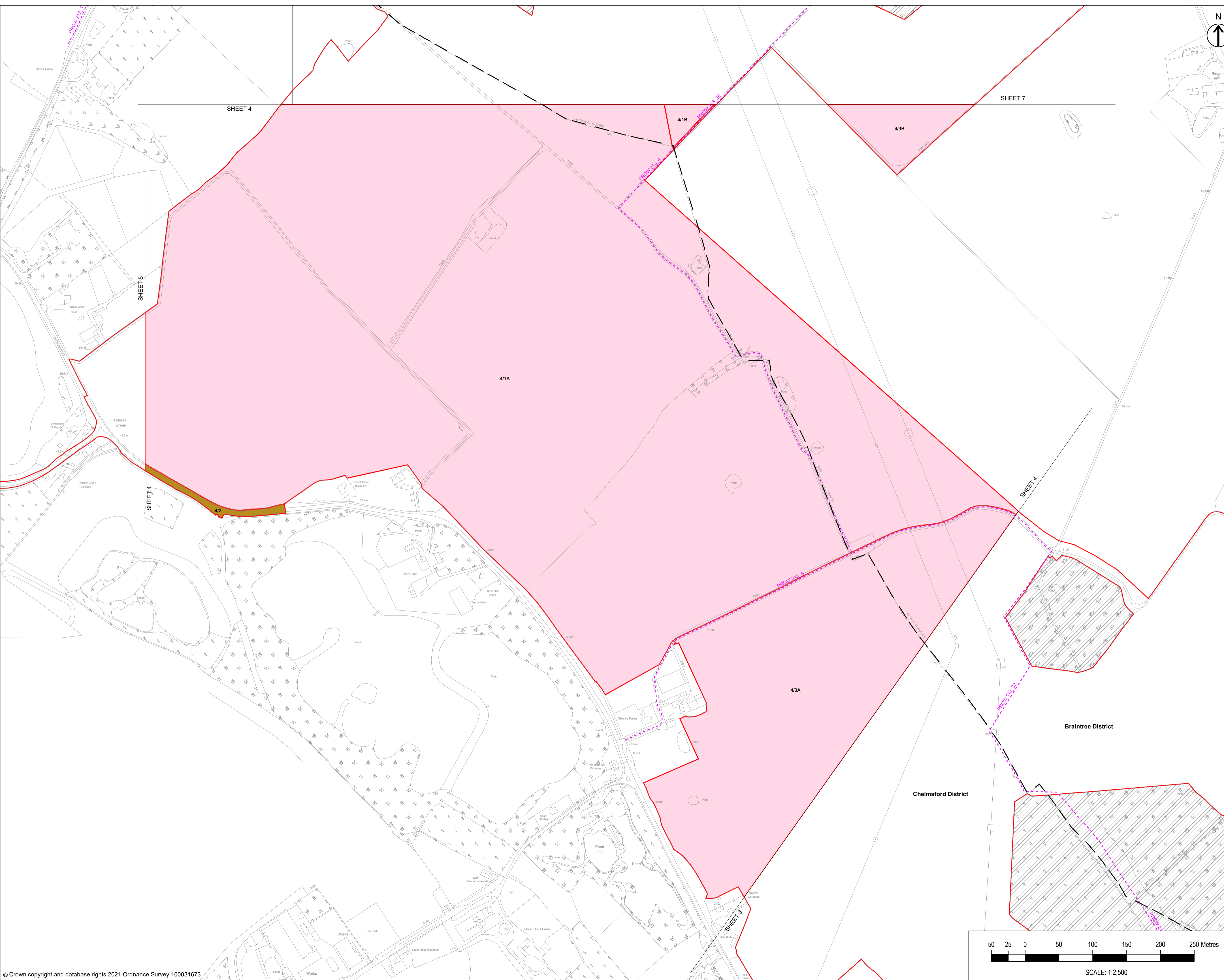

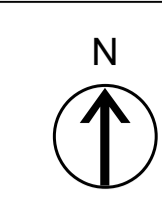

COPYRIGHT GATELEY HAMER LIMITED. THIS DOCUMENT HAS BEEN PREPARED PURSUANT TO AND SUBJECT TO THE TERMS OF APPOINTMENT BY THE CLIENT AND FOR THE SPECIFIC PURPOSES CONNECTED WITH THE PROJECT ONLY. IT SHOULD NOT BE RELIED UPON BY ANY OTHER PARTY OR USED FOR ANY OTHER PURPOSE. GATELEY HAMER ACCEPTS NO LIABILITY WHICH MAY ARISE FROM RELIANCE OR USE OF THIS DOCUMENT OR THE DATA CONTAINED HEREIN BY ANY OTHER PARTY OR FOR ANY OTHER PURPOSE.

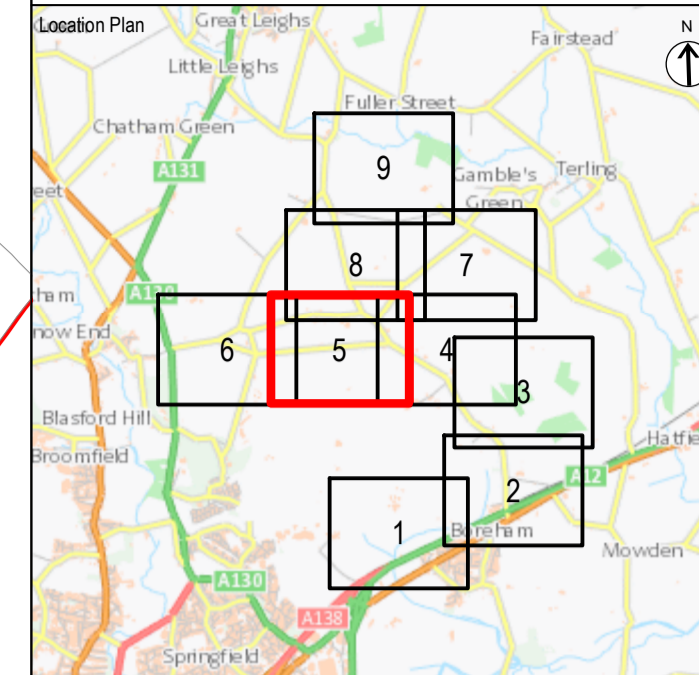

- Notes
1. DO NOT SCALE FROM THIS DRAWING. USE ONLY PRINTED DIMENSIONS
 2. ALL DIMENSIONS ARE IN METRES UNLESS STATED OTHERWISE
 3. THIS DRAWING IS TO BE READ IN CONJUNCTION WITH ALL OTHER RELEVANT DOCUMENTATION

- Key to Symbols
- Order limits – the area within which the authorised development may be carried out.
 - For clarity, land hatched does not fall within the Order limits or Order land.
 - Order land - freehold to be compulsorily acquired and in relation to which it is proposed to extinguish easements, servitudes and other private rights.
 - Order land – temporary use of land and during any period of temporary possession the exercise of easements, servitudes and other private rights are to be suspended.
 - Order land - new rights to be compulsorily acquired and restrictive covenants to be imposed and land in relation to which existing easements, servitudes and other private rights the exercise of which is inconsistent with the rights and restrictions acquired pursuant to the Order are to be extinguished.
 - Order land - new rights to be compulsorily acquired and restrictive covenants to be imposed and land in relation to which existing easements, servitudes and other private rights the exercise of which is inconsistent with the rights and restrictions acquired pursuant to the Order are to be extinguished. No new rights to be compulsorily acquired, restrictive covenants imposed, nor extinguishment of existing rights etc, in relation to the subsoil of this Order land.
 - Order land – in respect of subsoil only freehold to be compulsorily acquired and in relation to which it is proposed to extinguish easement, servitudes and other private rights.
 - Districts of Chelmsford and Braintree
 - Public Right of Way
 - Bridleway

CO1	First Issue	24/02/22	AH	SM	MD
Rev	Description	Date	By	Check	Approved

Purpose of Issue
DCO APPLICATION

Gateley / HAMER
 One Eleven Edmund Street
 Birmingham B3 2HJ
 Client
 Tel: 0121 234 0000
 Web: gateleyhamer.com

LONGFIELD SOLAR ENERGY FARM LIMITED

Project Title
LONGFIELD SOLAR FARM

Drawing Title
LAND PLAN IN ACCORDANCE WITH REGULATION 5(2)(i) OF THE INFRASTRUCTURE PLANNING (APPLICATIONS: PRESCRIBED FORMS AND PROCEDURE) REGULATIONS 2009 SHEET 5 OF 9

Drawn	Checked	Approved	Date
AH	SM	MD	24/02/22
GH Project Number	Scale at A1		
125724.005	1:2,500		
Drawing Number	Revision		
GH-125724005-LP-5	C01		

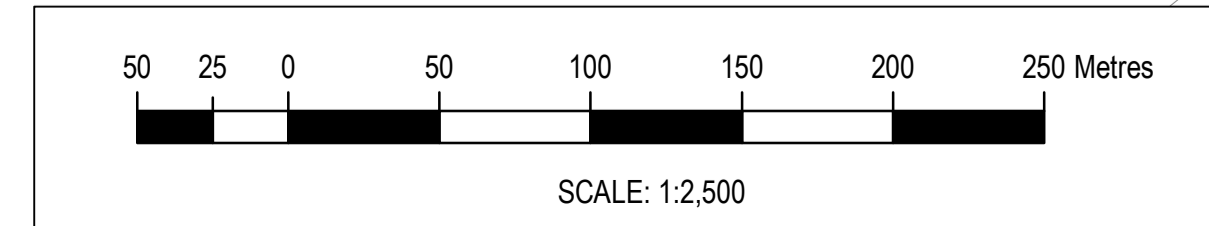
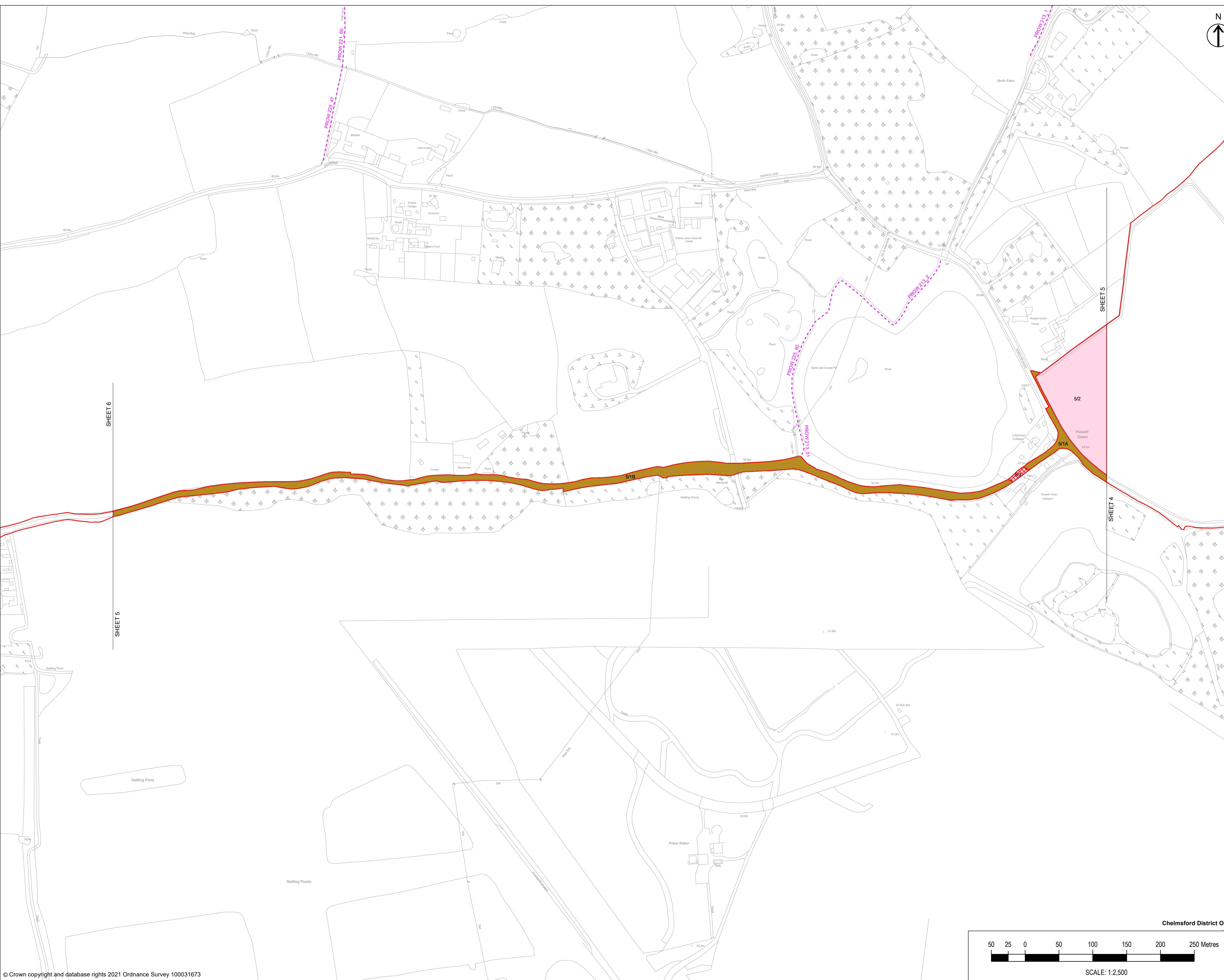

INSET 1
SCALE 1:500

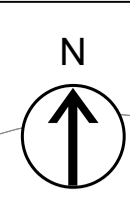
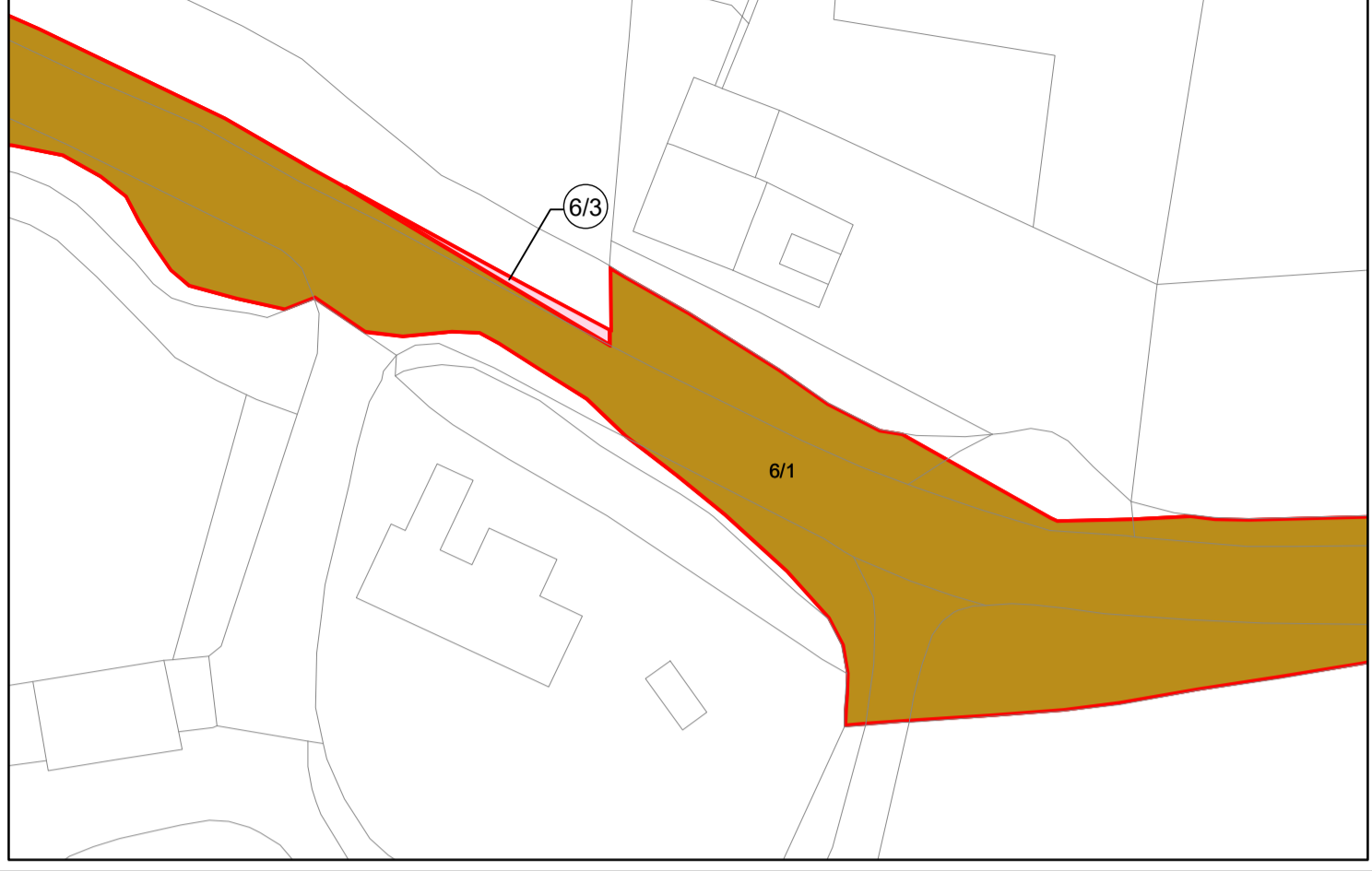

COPYRIGHT GATELEY HAMER LIMITED. THIS DOCUMENT HAS BEEN PREPARED PURSUANT TO AND SUBJECT TO THE TERMS OF APPOINTMENT BY THE CLIENT AND FOR THE SPECIFIC PURPOSES CONNECTED WITH THE PROJECT ONLY. IT SHOULD NOT BE RELIED UPON BY ANY OTHER PARTY OR USED FOR ANY OTHER PURPOSE. GATELEY HAMER ACCEPTS NO LIABILITY WHICH MAY ARISE FROM RELIANCE OR USE OF THIS DOCUMENT OR THE DATA CONTAINED HEREIN BY ANY OTHER PARTY OR FOR ANY OTHER PURPOSE.

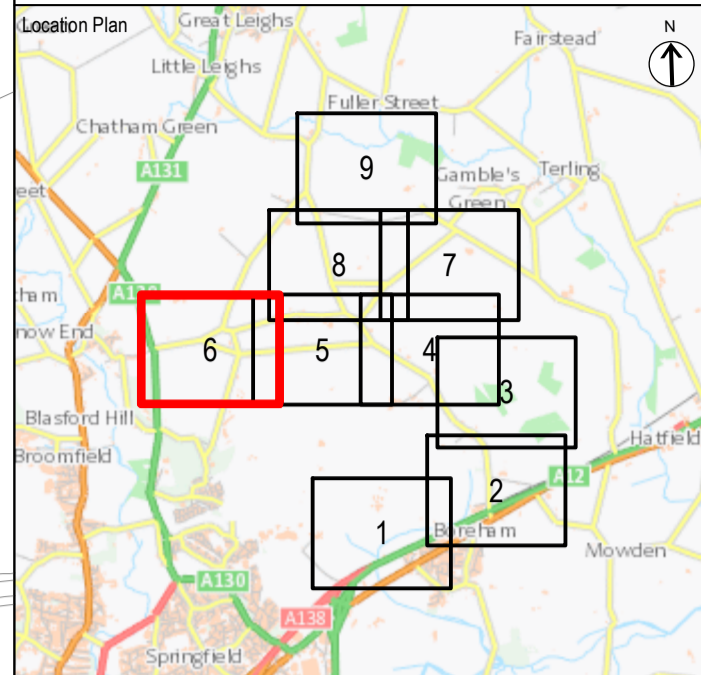

- Notes
- DO NOT SCALE FROM THIS DRAWING. USE ONLY PRINTED DIMENSIONS
 - ALL DIMENSIONS ARE IN METRES UNLESS STATED OTHERWISE
 - THIS DRAWING IS TO BE READ IN CONJUNCTION WITH ALL OTHER RELEVANT DOCUMENTATION

- Key to Symbols
- Order limits - the area within which the authorised development may be carried out.
 - For clarity, land hatched does not fall within the Order limits or Order land.
 - Order land - freehold to be compulsorily acquired and in relation to which it is proposed to extinguish easements, servitudes and other private rights.
 - Order land - temporary use of land and during any period of temporary possession the exercise of easements, servitudes and other private rights are to be suspended.
 - Order land - new rights to be compulsorily acquired and restrictive covenants to be imposed and land in relation to which existing easements, servitudes and other private rights the exercise of which is inconsistent with the rights and restrictions acquired pursuant to the Order are to be extinguished.
 - Order land - new rights to be compulsorily acquired and restrictive covenants to be imposed and land in relation to which existing easements, servitudes and other private rights the exercise of which is inconsistent with the rights and restrictions acquired pursuant to the Order are to be extinguished. No new rights to be compulsorily acquired, restrictive covenants imposed, nor extinguishment of existing rights etc, in relation to the subsol of this Order land.
 - Order land - in respect of subsol only freehold to be compulsorily acquired and in relation to which it is proposed to extinguish easement, servitudes and other private rights.
 - Districts of Chelmsford and Braintree
 - Public Right of Way
 - Bridleway

CO1	First Issue	24/02/22	AH	SM	MD
Rev	Description	Date	By	Check	Approved

Purpose of Issue
DCO APPLICATION

Gateley / HAMER
One Eleven Edmund Street
Birmingham B3 2HJ
Tel: 0121 234 0000
Web: gateleyhamer.com

Client
LONGFIELD SOLAR ENERGY FARM LIMITED

Project Title
LONGFIELD SOLAR FARM

Drawing Title
LAND PLAN IN ACCORDANCE WITH REGULATION 5(2)(i) OF THE INFRASTRUCTURE PLANNING (APPLICATIONS: PRESCRIBED FORMS AND PROCEDURE) REGULATIONS 2009 SHEET 6 OF 9

Drawn	Checked	Approved	Date
AH	SM	MD	24/02/22
GH Project Number	Scale at A1		
125724.005	1:2,500		
Drawing Number	Revision		
GH-125724005-LP-6	C01		

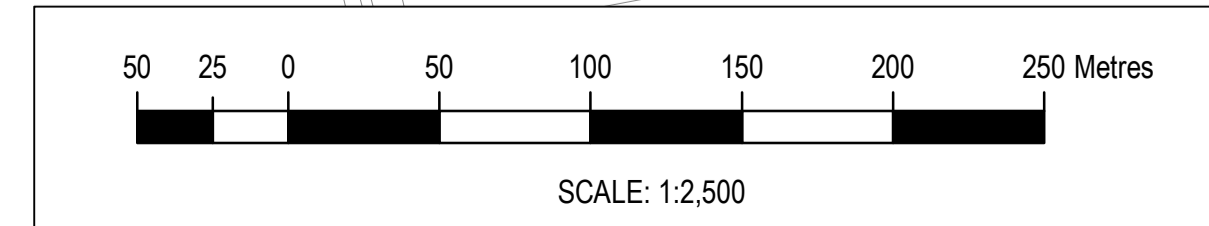

COPYRIGHT GATELEY HAMER LIMITED. THIS DOCUMENT HAS BEEN PREPARED PURSUANT TO AND SUBJECT TO THE TERMS OF APPOINTMENT BY THE CLIENT AND FOR THE SPECIFIC PURPOSES CONNECTED WITH THE PROJECT ONLY. IT SHOULD NOT BE RELIED UPON BY ANY OTHER PARTY OR USED FOR ANY OTHER PURPOSE. GATELEY HAMER ACCEPTS NO LIABILITY WHICH MAY ARISE FROM RELIANCE OR USE OF THIS DOCUMENT OR THE DATA CONTAINED HEREIN BY ANY OTHER PARTY OR FOR ANY OTHER PURPOSE.

- Notes
1. DO NOT SCALE FROM THIS DRAWING. USE ONLY PRINTED DIMENSIONS
 2. ALL DIMENSIONS ARE IN METRES UNLESS STATED OTHERWISE
 3. THIS DRAWING IS TO BE READ IN CONJUNCTION WITH ALL OTHER RELEVANT DOCUMENTATION

Key to Symbols

- Order limits – the area within which the authorised development may be carried out.
- For clarity, land hatched does not fall within the Order limits or Order land.
- Order land - freehold to be compulsorily acquired and in relation to which it is proposed to extinguish easements, servitudes and other private rights.
- Order land - temporary use of land and during any period of temporary possession the exercise of easements, servitudes and other private rights are to be suspended.
- Order land - new rights to be compulsorily acquired and restrictive covenants to be imposed and land in relation to which existing easements, servitudes and other private rights the exercise of which is inconsistent with the rights and restrictions acquired pursuant to the Order are to be extinguished.
- Order land - new rights to be compulsorily acquired and restrictive covenants to be imposed and land in relation to which existing easements, servitudes and other private rights the exercise of which is inconsistent with the rights and restrictions acquired pursuant to the Order are to be extinguished. No new rights to be compulsorily acquired, restrictive covenants imposed, nor extinguishment of existing rights etc, in relation to the subsoil of this Order land.
- Order land - in respect of subsoil only freehold to be compulsorily acquired and in relation to which it is proposed to extinguish easement, servitudes and other private rights.
- Districts of Chelmsford and Braintree
- Public Right of Way
- Bridleway

CO1	First Issue	24/02/22	AH	SM	MD
Rev	Description	Date	By	Check	Approved

Purpose of Issue
DCO APPLICATION

Gateley / HAMER
 One Eleven Edmund Street
 Birmingham B3 2HJ
 Client
 Tel: 0121 234 0000
 Web: gateleyhamer.com

LONGFIELD SOLAR ENERGY FARM LIMITED

Project Title
LONGFIELD SOLAR FARM

Drawing Title
LAND PLAN IN ACCORDANCE WITH REGULATION 5(2)(i) OF THE INFRASTRUCTURE PLANNING (APPLICATIONS: PRESCRIBED FORMS AND PROCEDURE) REGULATIONS 2009 SHEET 7 OF 9

Drawn	Checked	Approved	Date
AH	SM	MD	24/02/22
GH Project Number	Scale at A1		
125724.005	1:2,500		
Drawing Number	Revision		
GH-125724005-LP-7	C01		

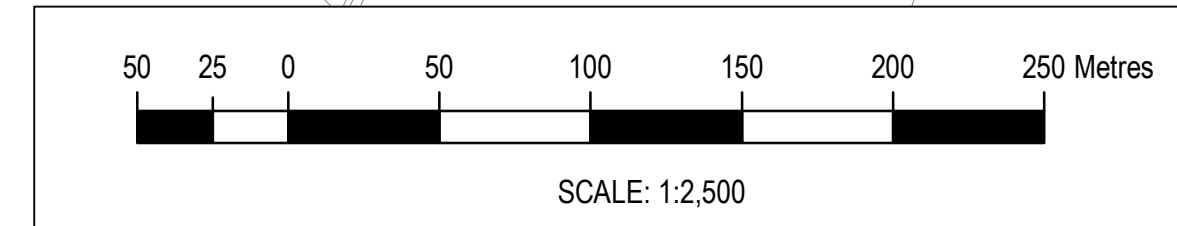
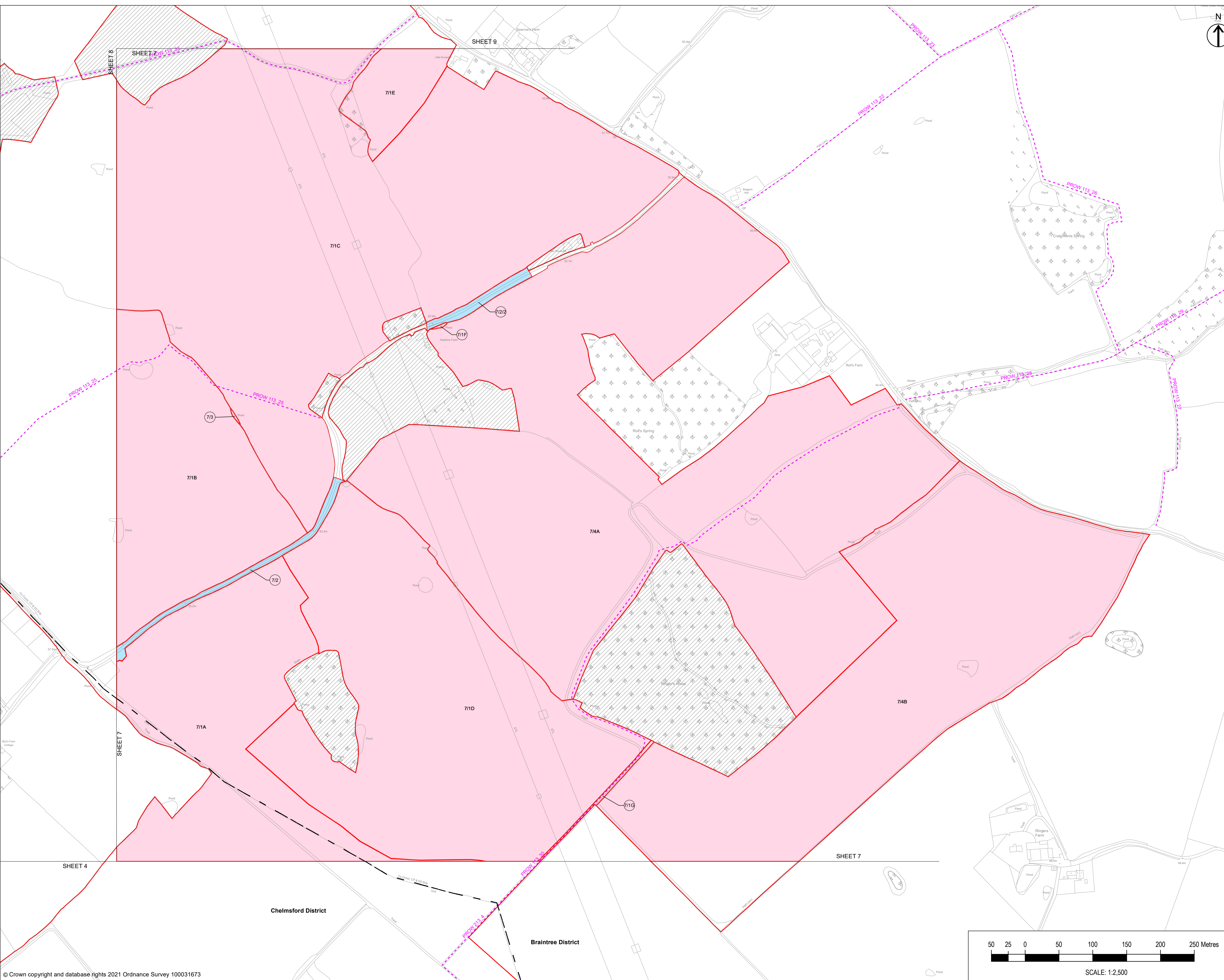

COPYRIGHT GATELEY HAMER LIMITED. THIS DOCUMENT HAS BEEN PREPARED PURSUANT TO AND SUBJECT TO THE TERMS OF APPOINTMENT BY THE CLIENT AND FOR THE SPECIFIC PURPOSES CONNECTED WITH THE PROJECT ONLY. IT SHOULD NOT BE RELIED UPON BY ANY OTHER PARTY OR USED FOR ANY OTHER PURPOSE. GATELEY HAMER ACCEPTS NO LIABILITY WHICH MAY ARISE FROM RELIANCE OR USE OF THIS DOCUMENT OR THE DATA CONTAINED HEREIN BY ANY OTHER PARTY OR FOR ANY OTHER PURPOSE.

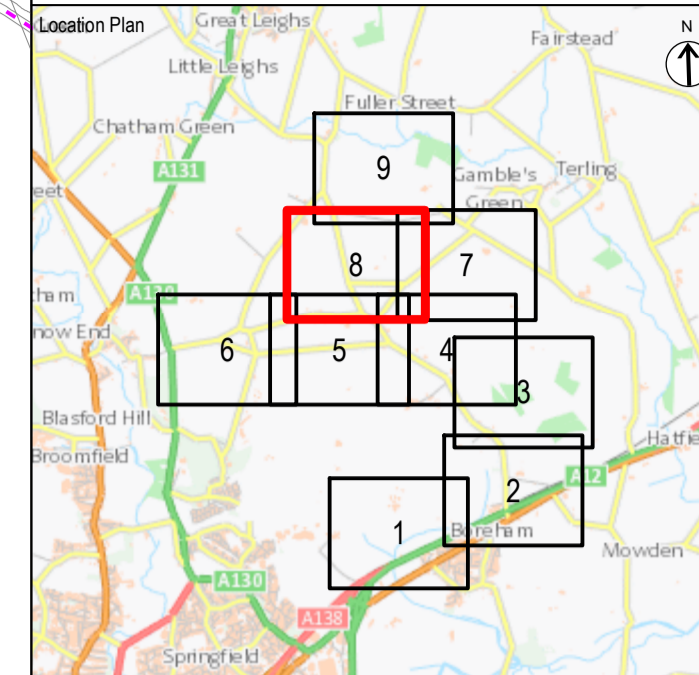

- Notes
- DO NOT SCALE FROM THIS DRAWING. USE ONLY PRINTED DIMENSIONS
 - ALL DIMENSIONS ARE IN METRES UNLESS STATED OTHERWISE
 - THIS DRAWING IS TO BE READ IN CONJUNCTION WITH ALL OTHER RELEVANT DOCUMENTATION

- Key to Symbols
- Order limits – the area within which the authorised development may be carried out.
 - For clarity, land hatched does not fall within the Order limits or Order land.
 - Order land - freehold to be compulsorily acquired and in relation to which it is proposed to extinguish easements, servitudes and other private rights.
 - Order land - temporary use of land and during any period of temporary possession the exercise of easements, servitudes and other private rights are to be suspended.
 - Order land - new rights to be compulsorily acquired and restrictive covenants to be imposed and land in relation to which existing easements, servitudes and other private rights the exercise of which is inconsistent with the rights and restrictions acquired pursuant to the Order are to be extinguished.
 - Order land - new rights to be compulsorily acquired and restrictive covenants to be imposed and land in relation to which existing easements, servitudes and other private rights the exercise of which is inconsistent with the rights and restrictions acquired pursuant to the Order are to be extinguished. No new rights to be compulsorily acquired, restrictive covenants imposed, nor extinguishment of existing rights etc. in relation to the subsol of this Order land.
 - Order land – in respect of subsol only freehold to be compulsorily acquired and in relation to which it is proposed to extinguish easement, servitudes and other private rights.
 - Districts of Chelmsford and Braintree
 - Public Right of Way
 - Bridleway

CO1	First Issue	24/02/22	AH	SM	MD
Rev	Description	Date	By	Check	Approved

Purpose of Issue
DCO APPLICATION

Gateley / HAMER
 One Eleven Edmund Street
 Birmingham B3 2HJ
 Client
 Tel: 0121 234 0000
 Web: gateleyhamer.com

LONGFIELD SOLAR ENERGY FARM LIMITED

Project Title
LONGFIELD SOLAR FARM

Drawing Title
LAND PLAN IN ACCORDANCE WITH REGULATION 5(2)(i) OF THE INFRASTRUCTURE PLANNING (APPLICATIONS: PRESCRIBED FORMS AND PROCEDURE) REGULATIONS 2009 SHEET 8 OF 9

Drawn	Checked	Approved	Date
AH	SM	MD	24/02/22

GH Project Number
125724.005

Drawing Number
GH-125724005-LP-8

Scale at A1
1:2,500

Revision
C01

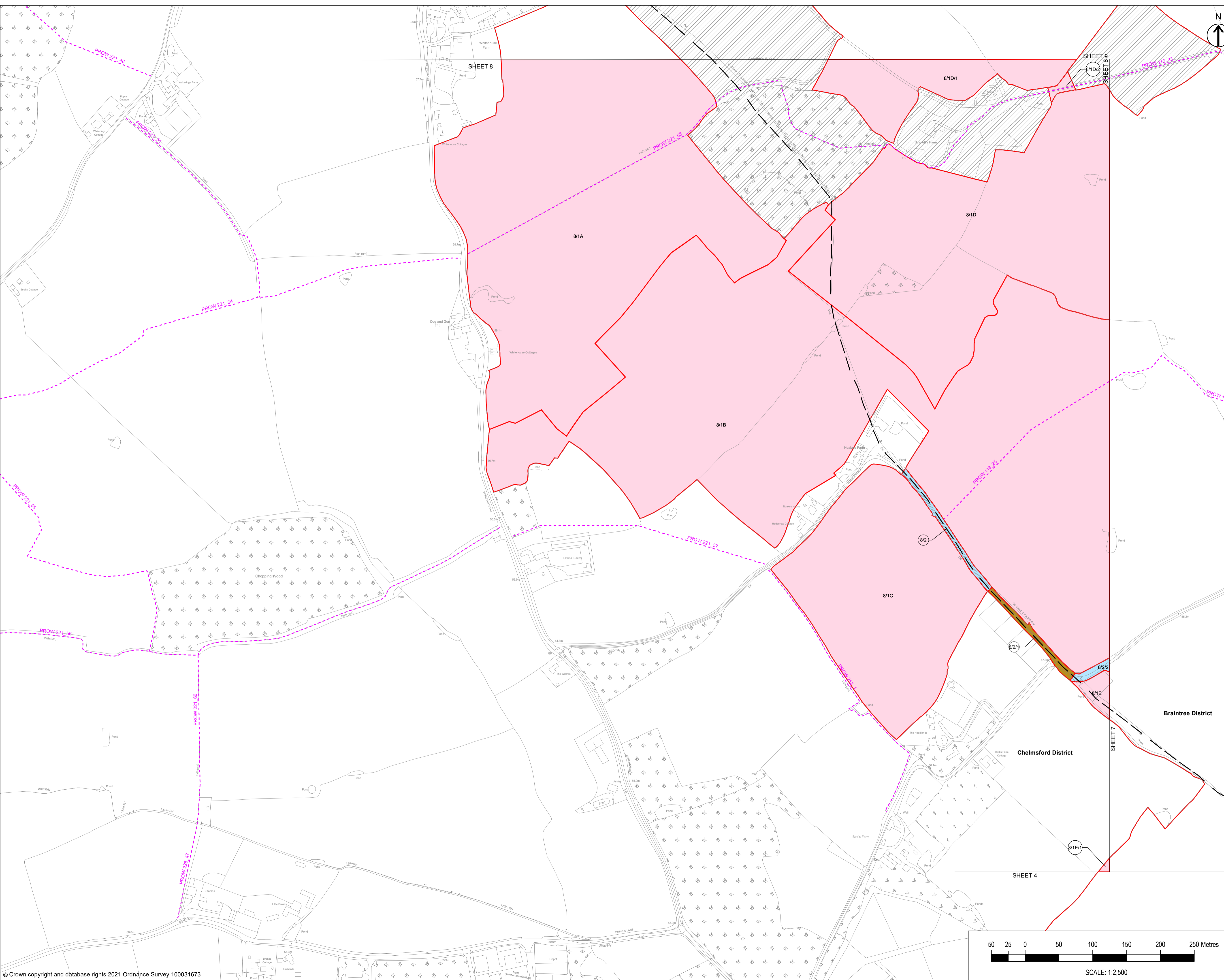

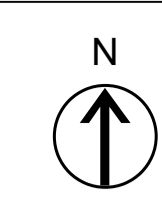

COPYRIGHT GATELEY HAMER LIMITED. THIS DOCUMENT HAS BEEN PREPARED PURSUANT TO AND SUBJECT TO THE TERMS OF APPOINTMENT BY THE CLIENT AND FOR THE SPECIFIC PURPOSES CONNECTED WITH THE PROJECT ONLY. IT SHOULD NOT BE RELIED UPON BY ANY OTHER PARTY OR USED FOR ANY OTHER PURPOSE. GATELEY HAMER ACCEPTS NO LIABILITY WHICH MAY ARISE FROM RELIANCE OR USE OF THIS DOCUMENT OR THE DATA CONTAINED HEREIN BY ANY OTHER PARTY OR FOR ANY OTHER PURPOSE.

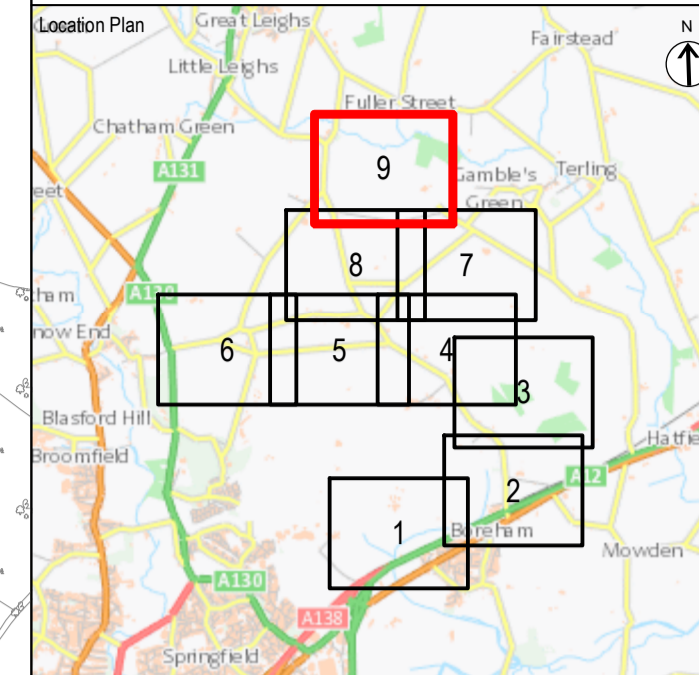

Notes

- DO NOT SCALE FROM THIS DRAWING. USE ONLY PRINTED DIMENSIONS
- ALL DIMENSIONS ARE IN METRES UNLESS STATED OTHERWISE
- THIS DRAWING IS TO BE READ IN CONJUNCTION WITH ALL OTHER RELEVANT DOCUMENTATION

Key to Symbols

- Order limits - the area within which the authorised development may be carried out.
- For clarity, land hatched does not fall within the Order limits or Order land.
- Order land - freehold to be compulsorily acquired and in relation to which it is proposed to extinguish easements, servitudes and other private rights.
- Order land - temporary use of land and during any period of temporary possession the exercise of easements, servitudes and other private rights are to be suspended.
- Order land - new rights to be compulsorily acquired and restrictive covenants to be imposed and land in relation to which existing easements, servitudes and other private rights the exercise of which is inconsistent with the rights and restrictions acquired pursuant to the Order are to be extinguished.
- Order land - new rights to be compulsorily acquired and restrictive covenants to be imposed and land in relation to which existing easements, servitudes and other private rights the exercise of which is inconsistent with the rights and restrictions acquired pursuant to the Order are to be extinguished. No new rights to be compulsorily acquired, restrictive covenants imposed, nor extinguishment of existing rights etc, in relation to the subsoil of this Order land.
- Order land - in respect of subsoil only freehold to be compulsorily acquired and in relation to which it is proposed to extinguish easement, servitudes and other private rights.
- Districts of Chelmsford and Braintree
- Public Right of Way
- Bridleway

C01	First Issue	24/02/22	AH	SM	MD
Rev	Description	Date	By	Check	Approved

Purpose of Issue
DCO APPLICATION

Gateley / HAMER
 One Eleven Edmund Street
 Birmingham B3 2HJ
 Client
 Tel: 0121 234 0000
 Web: gateleyhamer.com

LONGFIELD SOLAR ENERGY FARM LIMITED

Project Title
LONGFIELD SOLAR FARM

Drawing Title
LAND PLAN IN ACCORDANCE WITH REGULATION 5(2)(i) OF THE INFRASTRUCTURE PLANNING (APPLICATIONS: PRESCRIBED FORMS AND PROCEDURE) REGULATIONS 2009 SHEET 9 OF 9

Drawn	Checked	Approved	Date
AH	SM	MD	24/02/22

GH Project Number
125724.005

Drawing Number
GH-125724005-LP-9

Scale at A1
1:2,500

Revision
C01

